

Southend High School for Boys playing fields

Appendix 1

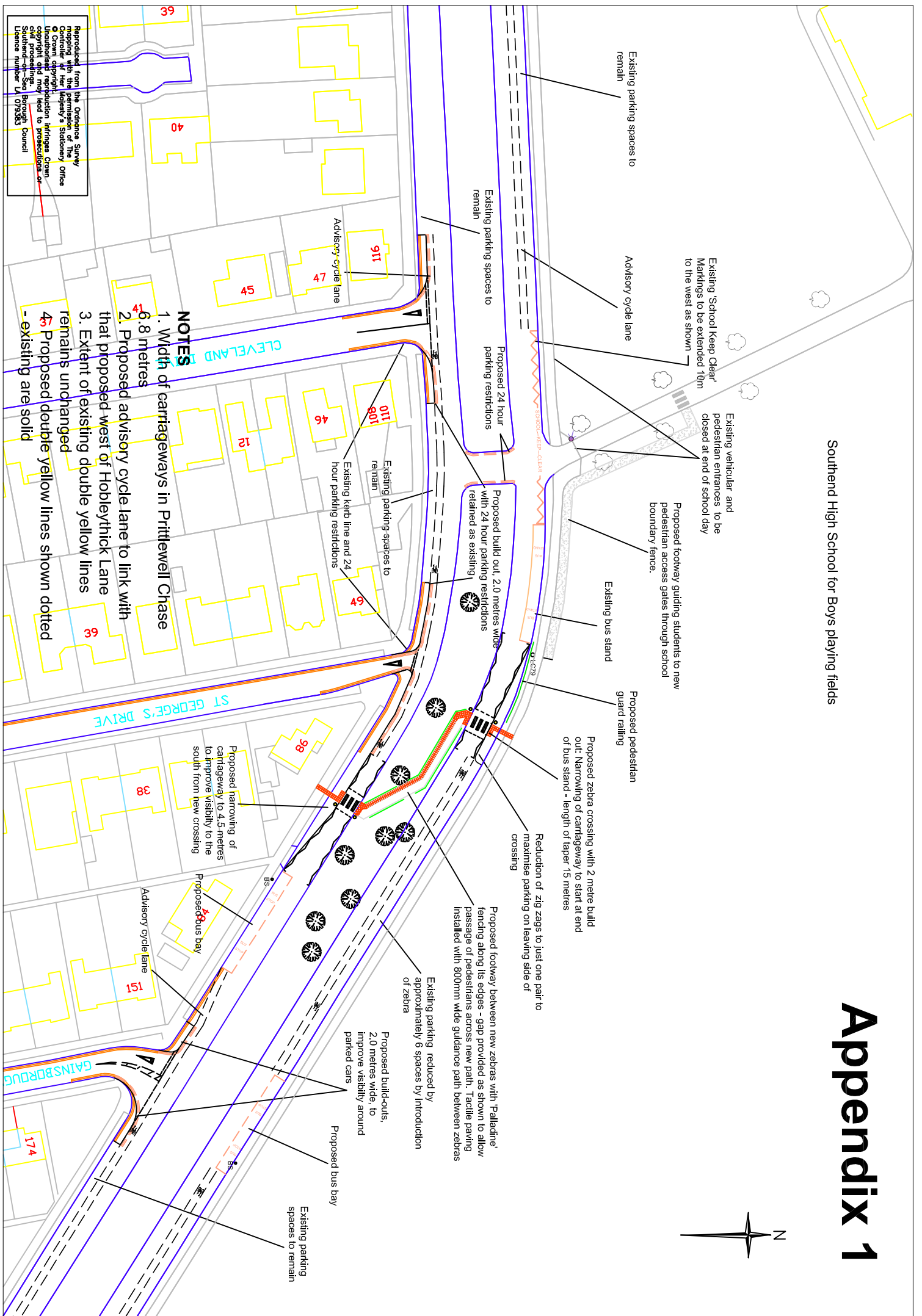

Existing 'School Keep Clear' Markings to be extended 10m to the west as shown

Existing vehicular and pedestrian entrances to be closed at end of school day

Proposed footway guiding students to new pedestrian access gates through school boundary fence.

Existing bus stand

Proposed pedestrian guard railing

Proposed zebra crossing with 2 metre build out: Narrowing of carriageway to start at end of bus stand - length of taper 15 metres

Reduction of zig zags to just one pair to maximise parking on leaving side of crossing

Proposed footway between new zebra crossings with 'Palladiade' fencing along its edges - gap provided as shown to allow passage of pedestrians across new path. Tactile paving installed with 800mm wide guidance path between zebra crossings

Existing parking reduced by approximately 6 spaces by introduction of zebra

Proposed build-outs, 2.0 metres wide, to improve visibility around parked cars

Proposed bus bay

Proposed narrowing of carriageway to 4.5 metres to improve visibility to the south from new crossing

Proposed bus bay

Advisory cycle lane

Existing parking spaces to remain

Proposed 24 hour parking restrictions

Proposed build out, 2.0 metres wide with 24 hour parking restrictions retained as existing

Existing parking spaces to remain

Existing kerb line and 24 hour parking restrictions

Advisory cycle lane

Reproduced from the Ordnance Survey MasterMap product. Crown copyright. Unauthorised reproduction infringes Crown copyright and may lead to prosecution and/or a fine and/or imprisonment. Licence number LA 079383

- NOTES**
1. Width of carriageways in Prittlewell Chase 6.8 metres
 2. Proposed advisory cycle lane to link with that proposed west of Hopleythick Lane remains unchanged
 3. Extent of existing double yellow lines remains unchanged
 4. Proposed double yellow lines shown dotted - existing are solid